

ET-PDLN

Networkx Trilogy® Panic Exit Device Trim

(Mount Battery Box Above
Exit Trim Device)

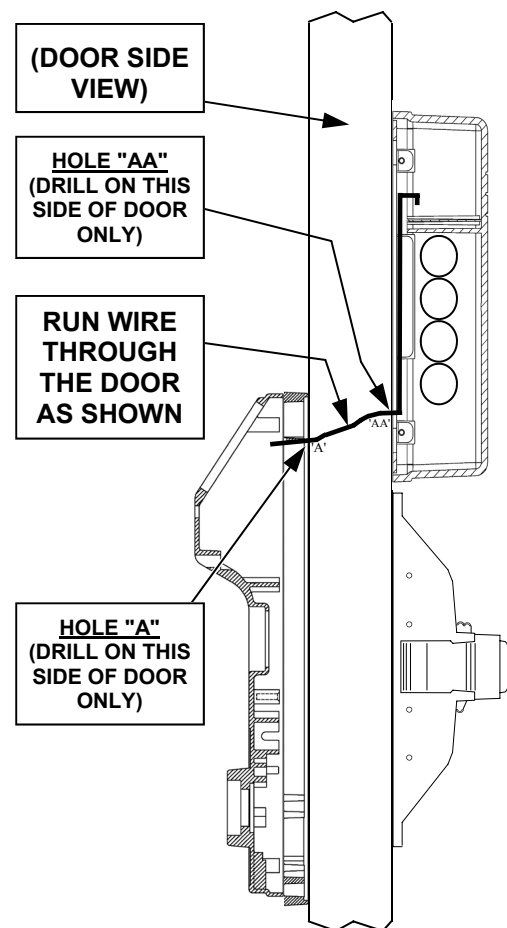

Yale

Model 7100
Rim Exit Device

Mount Battery Box ABOVE Lock

START HERE:

1. Tools Needed:

For new installations, see exit device instructions. For existing installations: Tape measure, drill, drill bits 5/16", 3/4" and 1/4" with extra-long shaft, Phillips screwdriver #2 & #3, level, 1" hole saw (for rim cylinder installations).

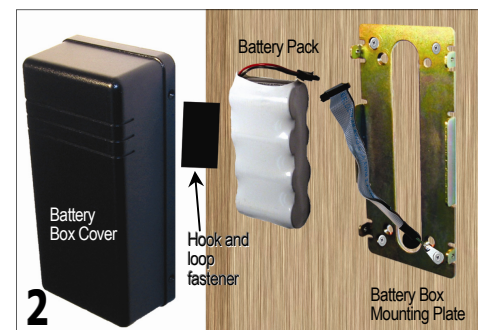

2. Find Battery Box Parts. See above image for Battery Box parts.



3. Existing Installation: Remove exit device from door.

Prepare Templates: If you are using templates printed from an computer PDF file, templates must be printed without size modifications and verified for dimensional accuracy. To ensure correct scale, measure the dimensions of the box indicated on the template (example shown at right).

ENSURE THIS
BOX IS
1/2 INCH
X
1/2 INCH

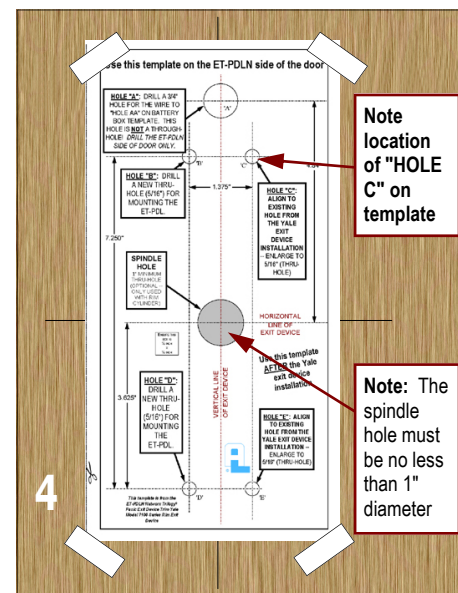

4. Mark Holes on ET-PDLN Side of Door

Cut out the template marked "Use this template on the ET-PDLN side of the door" (shown above).

New Installation: Using the Yale device instructions and template, temporarily install Yale exit device on door. Remove Yale exit device. Continue with "Existing Installation" instructions.

Existing Installation: With Yale exit device removed from door, position the Alarm Lock template on horizontal & vertical lines of existing spindle hole (on the ET-PDLN side of the door). Align template HOLE "C" and HOLE "E" to existing holes used to secure the Yale exit device. Tape Alarm Lock template to door as shown.

Mark Holes: For "HOLE A" (NOT A thru-hole), mark hole on the ET-PDLN side of the door only. If installing a rim cylinder, mark the 1" "SPINDLE HOLE" (thru-hole). Mark HOLE "B" and "D" (thru-holes).

Drill Holes:

All Doors: Drill HOLE "B" and "D" (thru-holes). If installing a rim cylinder, drill the 1-inch "SPINDLE HOLE" (thru-hole).

For Hollow Doors: Drill "HOLE A" on the ET-PDLN side of the door surface ONLY (NOT a thru-hole).

For Solid Wood Doors: Drill "HOLE A" on the ET-PDLN side of the door ONLY about 1/2" deep (NOT a thru-hole). **Note:** The other end of "HOLE A" is "HOLE AA" to be drilled in the next step.

Take a moment to note the location of HOLES "B" and "C" on both Alarm Lock templates and on both sides of the door; these holes will be used again in the next step.

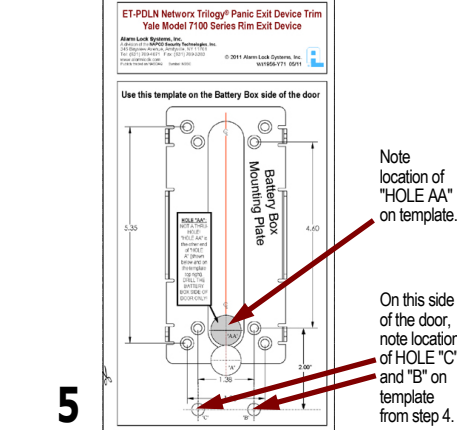

5. On Exit Device / Battery Box Side of Door

Recall the location of HOLES "B" and "C" in step 4. Using the **Battery Box Mounting Plate Template** (shown above) on the exit device/Battery Box side of the door, find and align HOLES "C" and "B" on the door with these holes on the template. Mark the location of "HOLE AA" and the holes for the Battery Box Mounting Plate.

For hollow doors: Use a 3/4" drill bit and drill "HOLE AA" into the exit device/Battery Box side of door surface ONLY (NOT a thru-hole).

For solid wood doors: Use a 3/4" drill bit and drill "HOLE AA" about 1/2" into the exit device/Battery Box side of the door. Using a 1/4" drill bit with an extra-long shaft, drill from "HOLE AA" to "HOLE A". Enlarge this 1/4" hole to 3/4" using the 3/4" drill bit.



6. Before positioning the Exterior Assembly on door, feed the ribbon cable and the green ground wire (with ring connector) through the 3/4" wire hole (from "HOLE A" to "HOLE AA" drilled in Step 5). Do not pinch or cut wires. Position the Exterior Assembly on door.

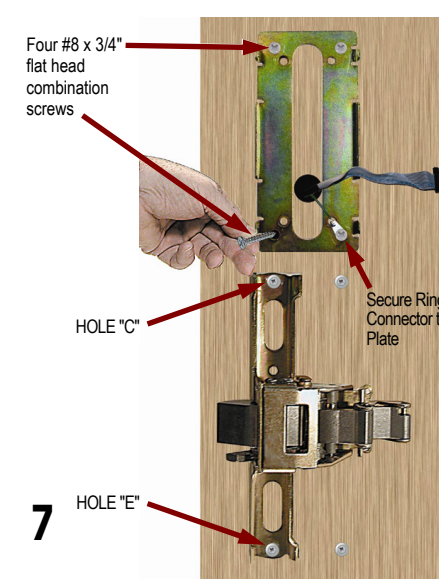

7. Replace Exit Device, insert and fasten with 4 provided mounting screws (do not over-tighten). **Note:** The mounting screws located at HOLES "C" and "E" secure both the Yale exit device and the Alarm Lock ET-PDLN device.

Secure the Battery Box Mounting Plate with four #8 x 3/4" flat head "combination" screws, using one of the screws to secure the green ground wire ring connector to the Plate.

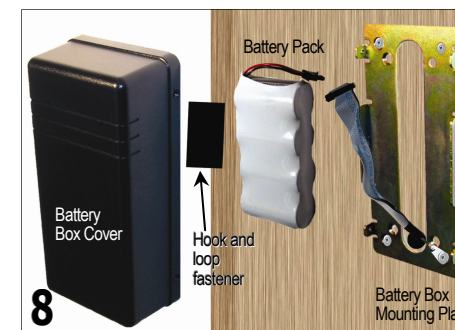

8. Connect the Battery Pack (batteries may be shrink wrapped as shown or may be inside a housing) and place inside of Battery Box Mounting Plate. Secure the Battery Pack inside the Battery Box Cover with the hook and loop fastener (provided). Position the Cover and fasten with four #6-32 x 5/16" screws.



9. Replace and fasten exit device & battery box covers.

Check lock for proper operation before closing door.

To Change Cylinder



IMPORTANT:

When replacing cylinder, be sure to use the proper Cylinder Adapter and Tailpiece.

Alarm Lock Systems, Inc.
A division of the NAPCO Security Technologies, Inc.
345 Bayview Avenue, Amityville, NY 11701
Tel: (631) 789-4871 Fax: (631) 789-3383
www.alarmlock.com

Publicly traded on NASDAQ Symbol: NSSC

© 2011 Alarm Lock Systems, Inc.

WI1858A-Y71 05/11

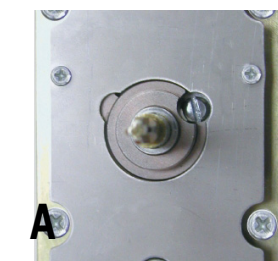
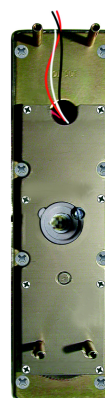

A. Remove Cover plate. Rotate the spindle either direction to expose and remove cylinder screws.

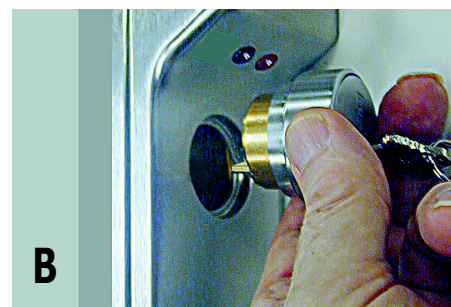

B. Remove old cylinder and insert new cylinder.

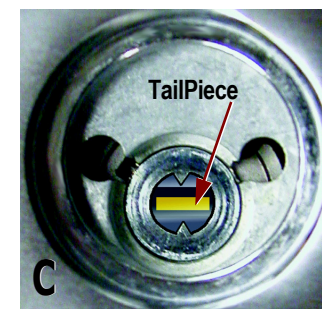

C. **Note:** The tailpiece must be in the horizontal position as shown in the image above.